

PRELIMINARY NOT FOR CONSTRUCTION

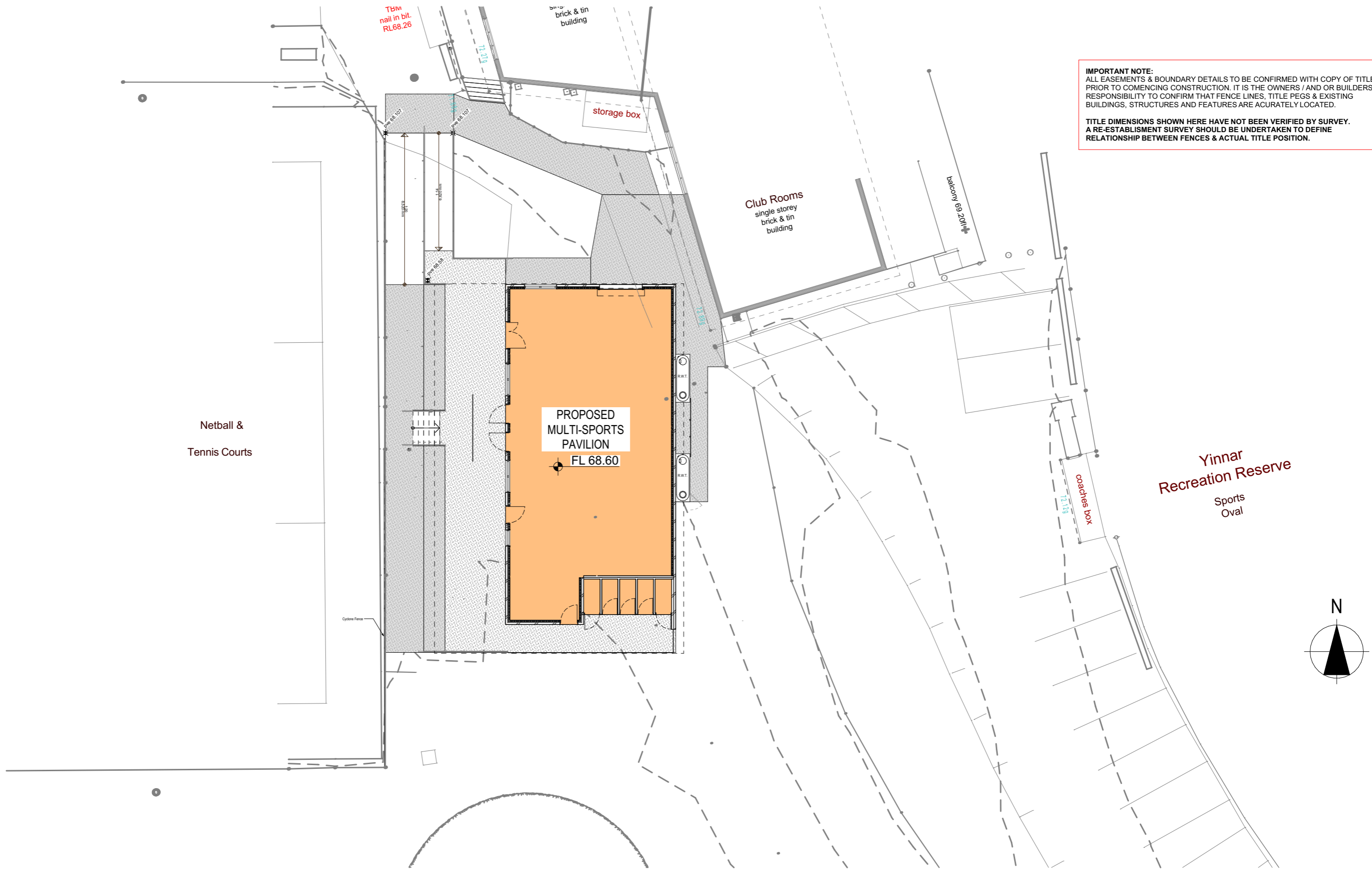

**IMPORTANT NOTE:**  
 ALL EASEMENTS & BOUNDARY DETAILS TO BE CONFIRMED WITH COPY OF TITLE PRIOR TO COMENCING CONSTRUCTION. IT IS THE OWNERS / AND OR BUILDERS RESPONSIBILITY TO CONFIRM THAT FENCE LINES, TITLE PEGS & EXISTING BUILDINGS, STRUCTURES AND FEATURES ARE ACURATELY LOCATED.

TITLE DIMENSIONS SHOWN HERE HAVE NOT BEEN VERIFIED BY SURVEY. A RE-ESTABLISHMENT SURVEY SHOULD BE UNDERTAKEN TO DEFINE RELATIONSHIP BETWEEN FENCES & ACTUAL TITLE POSITION.

**SITE PLAN**  
 1:200

**CONCEPT DESIGN**  
 CD00 - CONCEPT  
 3223  
 14/04/2026

**PROPOSED MULTI-SPORTS PAVILION**  
 JUMBUCK ROAD, YINNAR VIC 3869  
 LATROBE CITY COUNCIL

**JJC DESIGN**  
 & ASSOCIATES PTY LTD

CLIENT APPROVAL: REVISE AS PER MARK-UPS - CONCEPT DESIGN - TOWN PLANNING - WORKING DRAWINGS (Please circle works required)  
 CLIENT NAME: DATE:  
 CLIENT SIGNATURE:

Unit 3, 6-16 Rocla Road  
 PO Box 9390  
 Traralgon Vic 3844  
 Phone: (03) 5176 1117  
 Fax: (03) 5176 1107  
 677 Victoria Street  
 Abbotsford Vic 3067  
 Phone: (03) 9429 2329  
 Email: info@jjcdesign.com.au

J. Couper  
 Building Practitioner  
 REG No. DP-AD2228

Z:\3223 - Latrobe City Council - Proposed Netball & Tennis Pavilion - Yinnar Recreation Reserve\CAD\3223 - Concept 03.pln

PRELIMINARY NOT FOR CONSTRUCTION

GROUND  
1:100



AREA SCHEDULE	
Room Type	Area
NETBALL CHANGEROOM 01	180.27
VERANDA	96.48
	<b>276.75 m²</b>

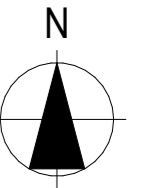

**CONCEPT DESIGN**  
CD01 - CONCEPT  
3223  
14/04/2026

**PROPOSED MULTI-SPORTS PAVILION**  
JUMBUCK ROAD, YINNAR VIC 3869  
LATROBE CITY COUNCIL

**JJC DESIGN**  
& ASSOCIATES PTY LTD

CLIENT APPROVAL: REVISE AS PER MARK-UPS - CONCEPT DESIGN - TOWN PLANNING - WORKING DRAWINGS (Please circle works required)  
CLIENT NAME: \_\_\_\_\_ DATE: \_\_\_\_\_  
CLIENT SIGNATURE: \_\_\_\_\_

Unit 3, 6-16 Rocla Road  
PO Box 9390  
Traralgon Vic 3844  
Phone: (03) 5176 1117  
Fax: (03) 5176 1107  
677 Victoria Street  
Abbotsford Vic 3067  
Phone: (03) 9429 2329  
Email: info@jjcdesign.com.au  
J.Couper  
Building Practitioner  
REG No. DP-AD2228

PRELIMINARY NOT FOR CONSTRUCTION



CONCEPT DESIGN

PROPOSED MULTI-SPORTS PAVILION

CD05 - CONCEPT  
3223  
14/04/2026

© Copyright JJC Design & Associates P/L  
A3 SHEET SIZE

JUMBUCK ROAD, YINNAR VIC 3869  
LATROBE CITY COUNCIL

**JJC DESIGN**  
& ASSOCIATES PTY LTD

CLIENT APPROVAL: REVISE AS PER MARK-UPS - CONCEPT DESIGN - TOWN PLANNING - WORKING DRAWINGS (Please circle works required)  
CLIENT NAME: DATE:  
CLIENT SIGNATURE:

Unit 3, 6-16 Rocla Road  
PO Box 9390  
Traralgon Vic 3844  
Phone: (03) 5176 1117  
Fax: (03) 5176 1107  
677 Victoria Street  
Abbotsford Vic 3067  
Phone: (03) 9429 2329  
Email: info@jjcdesign.com.au

J. Couper  
Building Practitioner  
REG No. DP-AD2228

Z:\3223 - Latrobe City Council - Proposed Netball & Tennis Pavilion - Yinnar Recreation Reserve\CAD\3223 - Concept 03.pln

PRELIMINARY NOT FOR CONSTRUCTION



CONCEPT DESIGN

PROPOSED MULTI-SPORTS PAVILION

CD06 - CONCEPT  
3223  
14/04/2026

© Copyright JJC Design & Associates P/L  
A3 SHEET SIZE

JUMBUCK ROAD, YINNAR VIC 3869  
LATROBE CITY COUNCIL

JJC DESIGN  
& ASSOCIATES PTY LTD

CLIENT APPROVAL: REVISE AS PER MARK-UPS - CONCEPT DESIGN - TOWN PLANNING - WORKING DRAWINGS (Please circle works required)  
CLIENT NAME: \_\_\_\_\_ DATE: \_\_\_\_\_  
CLIENT SIGNATURE: \_\_\_\_\_

Unit 3, 6-16 Rocla Road  
PO Box 9390  
Traralgon Vic 3844  
Phone: (03) 5176 1117  
Fax: (03) 5176 1107  
677 Victoria Street  
Abbotsford Vic 3067  
Phone: (03) 9429 2329  
Email: info@jjcdesign.com.au

J. Couper  
Building Practitioner  
REG No. DP-AD2228